

SECTION A-A

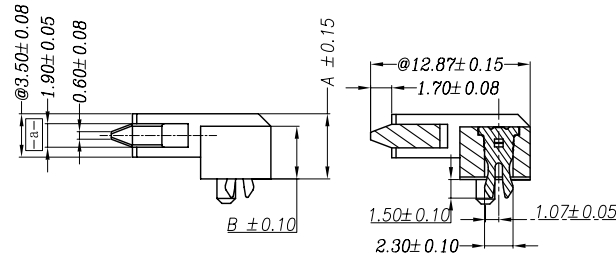

SECTION C-C

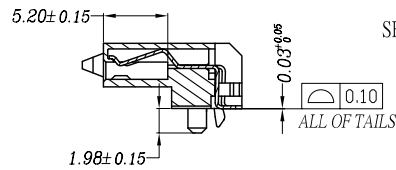

SECTION B-B

- 831M322** ** ** ** **
- | | |
|-----------|------------------|
| 05:NYLON | 01:RoHS |
| 07:LCP | 02:SONY |
| 05 足金15u" | 1241 :5.25H TYPE |
| 30 足金1u" | 1243 :5.0H TYPE |
| 06 足金30u" | 1244 :4.2H TYPE |

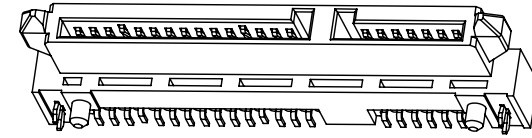

注意:

- 一.儲存環境: -20°C ~ +85°C.
- 絕緣阻抗: 100Mohm/Min.
- 耐壓測試: 500V AC,時間1分鐘以上.

三.材料:

- 1.主體材質: LCP,30% G/F UL94V-0;顏色:黑色.
- 2.端子材質:C5191-H,魚叉材質:C2680-RH
- 3.端子電鍍:鍍底50u"min;後部鍍錫100u"min
接觸區鍍金15u",30u"足金1u"三種
- 4.魚叉電鍍:鍍底50u"min,鍍全錫100u"min

